

TECHNICAL DETAILS

S.No.	Technical Parameter	Specifications	Test Method
1.	Coverage (Sq.Mt./Kg/Coat) [On Ideal smooth surface]*	8-10	In House
2.	Pot life (Hours)	3.0-3.5	In House
3.	Whiteness (% HW)	+94.5%	In House
4.	Drying time @ 25±2 °C -Touch Dry -Hard Dry	Max 1 hrs. Min. 6 hrs.	In House In House
5.	VOC (mg/kg)	Nil	ASTM 6886
6.	Bulk Density (g/cm 3)	0.80-0.90	In House

PRECAUTIONS

- Though it contains non-toxic materials, care should still be taken to avoid dust inhalation while mixing and handling. In case of contact with eyes or mouth, wash with plenty of clean water.
- Keep it in a dry place out of reach of children.
- Persons who are allergic to cement/cement products should take proper precautions before use.

STORAGE

Promix SkimPro should be stored in a dry place.

SHELF LIFE

12 months from the date of manufacturing.

MANUFACTURED & PACKAGED BY PROMIX MANUFACTURING CO. LTD.

📍 Shop No. 118, Hardware City, Nakasero
P.O Box 114654, Kampala Uganda.

☎ +256(0) 777 468467 | 704 659146

✉ operations@promixworld.com

🌐 promixworld.com

EXTOCARE PRIMERPRO

White Cement & Polymer-based Exterior Primer

- SUPER WHITENESS
- STRONGER ADHESION THAN ACRYLIC UNDERCOAT
- HIGH DURABILITY
- GOOD SEALING PROPERTIES
- MAKES SURFACES LESS ABSORBENT
- NO NEED OF CURING
- EASY TO MIX AND APPLY
- VALUE FOR MONEY



EXTOCARE PRIMERPRO

White Cement & Polymer-based Exterior Primer

ABOUT US

Promix is a Uganda's pioneer manufacturing company that makes white-cement-based premixed mortars for building construction and renovation products. The product range is wide with impeccable quality & competitive pricing. We are committed to continually offering you the best innovative ready-to-use building materials that will make your construction projects better, faster and economical. All our materials are tested and approved by the Uganda National Bureau of Standards (UNBS). They are expertly prepared and packaged with modern high-tech machinery.

PRODUCT DESCRIPTION

Extocare PrimerPro is a white cement-based and polymer based exterior wall primer that improves the quality and coverage of paints for a long-lasting, extra white and gives an attractive finish to the wall paint. It is perfect as an undercoat for all outdoor cementitious surfaces. It is an ideal combination of adhesion, strength, and durability because of its high filling abilities, porous surfaces are sealed and deeply penetrated.

SCOPE OF APPLICATION

This product may be used as primer without delay on Cement Plaster and RCC surfaces. It calls for no curing after application. It meets the needs of floor education on cement wall plaster perfectly. It fills pores and crevices making the wall floor equipped for further application of base coat (putty) and painting.

HOW TO USE EXTOCARE PRIMERPRO

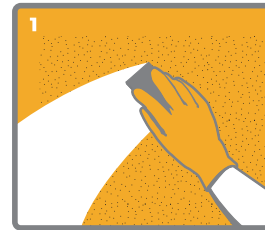

Surface Preparation. Clean the surface with sand paper and putty blade & remove loose particles.

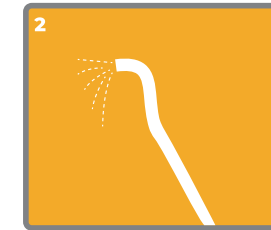

Pre-wet the surface extremely well with clean water

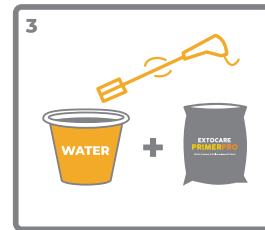

Mixing. Add 1:1 of clean water to Promix Extocare PrimerPro and mix using a mechanical mixer or by hand to make a uniform liquid mixture



Application. Apply 1 or 2 coats of Promix Extocare PrimerPro and let it dry completely overnight before applying paint over it.

↑ Plaster surface
↑ Acrylic Undercoat
↑ Extocare PrimerPro

